

DuroFlow® Industrial 30 Series Positive Displacement Blowers/Vacuum Pumps



For over forty years DuroFlow® blowers/vacuum pumps have combined leading-edge technology and on-the-job experience to continuously deliver enhanced designs and improved performance. The DuroFlow design has earned a reputation as a leader in reliability and efficiency for applications that demand a dependable supply of oil-free air.



Applications – DuroFlow blowers/vacuum pumps deliver clean, oil-free air to a wide range of applications that include wastewater treatment, methane gas recovery, combustion air, pneumatic conveying, process gas boosting, fluidized bed, vapor and gas extraction, composting and vacuum systems.

Key Features

RELIABLE SPLASH OIL LUBRICATION AT BOTH GEAR AND DRIVE ENDS – Provides superior gear and bearing lubrication for longer life at all operating conditions with minimal maintenance. Oversized double-row ball bearings support each shaft and fix rotor position.

HEAVY-DUTY REINFORCED SINGLE PIECE CAST IRON CYLINDER – Provides greater strength and rigidity to prevent distortion that can affect internal clearances and reduce performance. Extra cylinder mass and progressive porting aid in reducing noise.

ROTORS AND SHAFTS are machined from a single, high-strength ductile iron casting and dynamically balanced, assuring extra strength and rigidity to handle maximum loads on a continuous basis without fatigue, deflection or vibration.

VERTICAL OR HORIZONTAL MOUNTING CONFIGURATION AVAILABLE FOR EACH BLOWER – Provides flexibility for installing into any new or existing system.

QUALITY ASSURANCE – Every DuroFlow is manufactured under rigid ISO 9002 quality standards and exhaustively tested to meet strict performance criteria before shipping to ensure unequaled service life under the most severe operating conditions.



Positive Displacement Lobe Blowers/Vacuum Pumps

INDUSTRIAL 30 SERIES

- Airflow to 230 cfm
- Pressure to 15 psig
- Vacuum to 15 "Hg
- Proven performance and reliability
- Dual splash lubrication
- Heavy-duty design

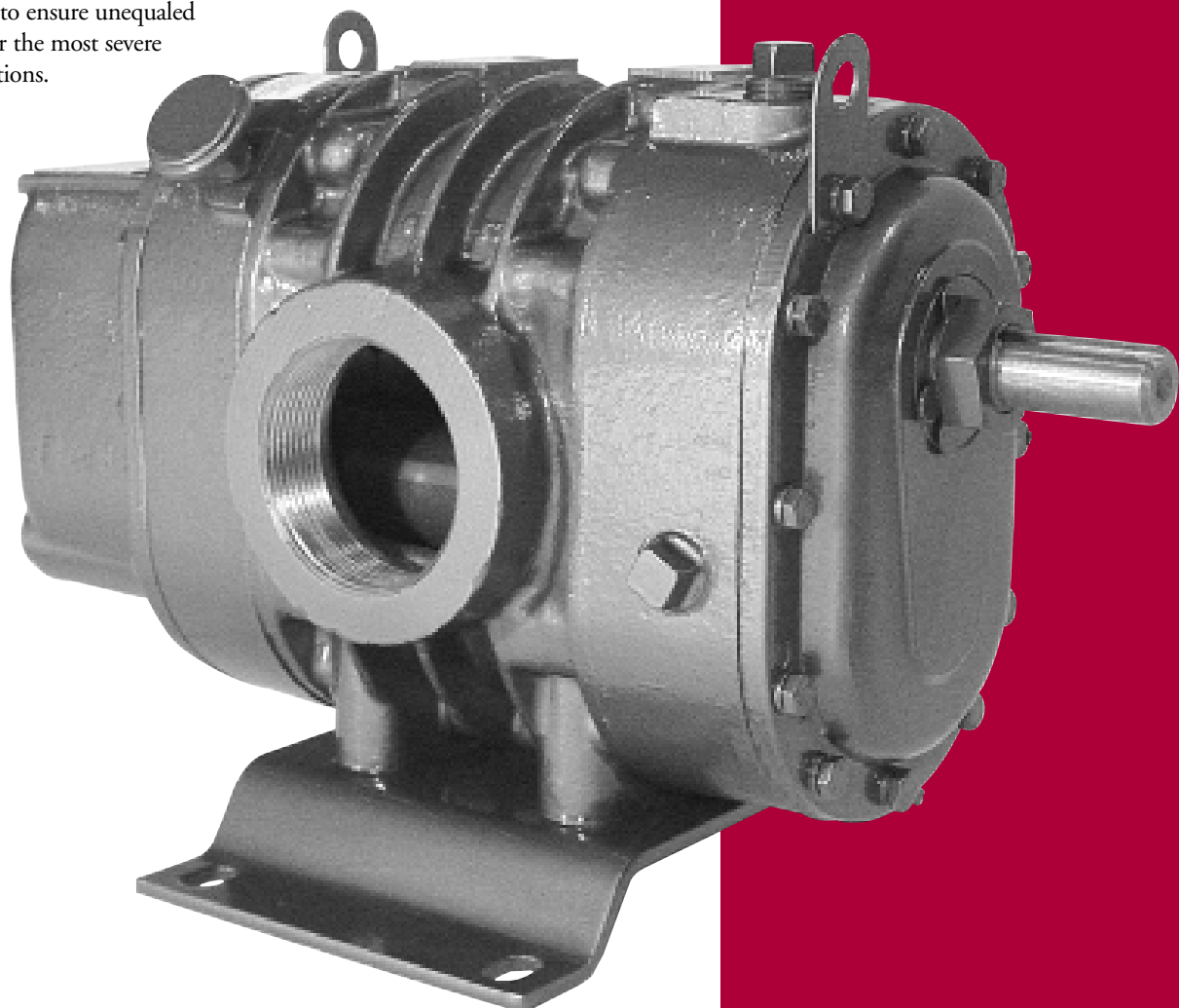

DIMENSIONAL DATA – DUROFLOW 30 SERIES

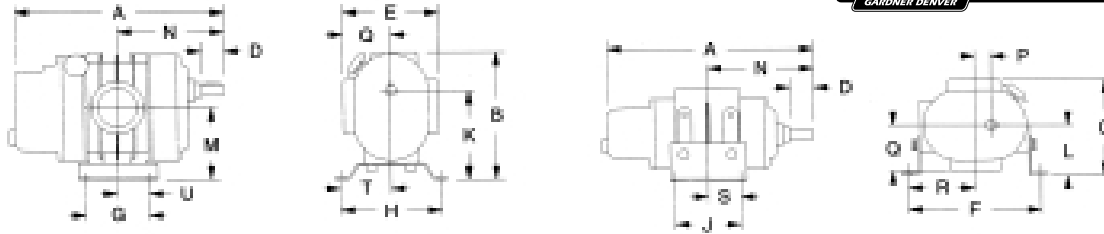

Model	Weight	Port Size Connectors	Mtg. Bolt Hole Dia.	Shaft Diameter	A	B	C	D	E	F	G	H	J	K	L	M	N	P	Q	R	S	T	U
3004	90 lbs.	2.5 NPT	0.56	1.00	16.64	11.62	8.81	2.00	8.62	12.50	4.00	9.00	4.00	8.06	4.50	6.56	8.35	1.50	4.31	7.75	2.00	4.50	2.00
3006	110 lbs.	3 NPT	0.56	1.00	18.64	11.62	8.81	2.00	8.62	12.50	5.50	9.00	5.50	8.06	4.50	6.56	9.35	1.50	4.31	7.75	2.75	4.50	2.75

All dimensions shown in inches. Dimensions for installation purposes provided upon request.

PRESSURE PERFORMANCE DATA

MODEL	RPM	4 PSIG		6 PSIG		8 PSIG		10 PSIG		12 PSIG		15 PSIG	
		CFM	BHP	CFM	BHP	CFM	BHP	CFM	BHP	CFM	BHP	CFM	BHP
3004	2,950	94	2.5	85	3.7	78	4.8	72	6.0	66	7.1		
	3,550	121	3.1	112	4.5	105	5.9	99	7.3	93	8.7	85	10.8
	4,000	141	3.6	133	5.2	125	6.8	119	8.3	113	9.9	105	12.3
3006	2,950	146	3.7	133	5.4	123	7.2	114	8.9	105	10.7		
	3,550	186	4.6	174	6.7	164	8.8	154	10.9	146	13.0	135	16.1
	4,000	217	5.2	205	7.6	194	10.0	185	12.4	177	14.7	165	18.3

VACUUM PERFORMANCE DATA

MODEL	RPM	4 "Hg		6 "Hg		8 "Hg		10 "Hg		12 "Hg		14 "Hg		15 "Hg	
		CFM	BHP	CFM	BHP	CFM	BHP	CFM	BHP	CFM	BHP	CFM	BHP	CFM	BHP
3004	2,950	104	1.3	96	1.9	88	2.5	80	3.0	72	3.6				
	3,550	131	1.7	123	2.4	115	3.1	107	3.8	99	4.5	90	5.1		
	4,000	151	2.0	143	2.8	135	3.6	127	4.4	119	5.1	110	5.9	106	6.3
3006	2,950	159	1.9	148	2.8	137	3.6	126	4.5	114	5.4	102	6.2		
	3,550	200	2.4	189	3.5	178	4.5	167	5.5	155	6.6	142	7.6	136	8.1
	4,000	231	2.8	219	4.0	208	5.2	197	6.3	186	7.5	173	8.7	166	9.2

Performance based on air at standard conditions: Sea Level, 14.7 PSIA, 68°F Inlet Temperature, 36% Relative Humidity. For performance with gases other than air or at non-standard conditions, contact your Authorized DuroFlow Industrial 30 Series Representative.

GENUINE GARDNER DENVER DUROFLOW PARTS

Maintain the DuroFlow Industrial 30 Series performance advantage and reliability with Genuine GD Replacement Parts, lubricants and performance matched accessories available through local professional sales and service representatives.



Other Gardner Denver Products Available



For additional information, contact your local representative or

Gardner Denver Blower Division

100 Gardner Park, Peachtree City, GA 30269

Toll Free 800-543-7736 ext. 501

Phone 770-632-5000 • Fax 770-486-5629

E-mail: blowersmktg@gardnerdenver.com

Visit our web site: www.gardnerdenver.com

For Parts Information, Contact:

Gardner Denver Blower Division Customer Service

Phone 770-632-5000 • Fax 770-486-5629

GLOBAL TECHNOLOGY & ENGINEERING
PO BOX 687
EXCELSIOR SPRINGS, MO 64024
TOLL FREE: 866-630-3500
WWW.GLOBALTECHENG.COM

Gardner Denver